

Lahnstein Court, Kettering NN16

"Location Location Location"

🛏 2 🚗 2 🚗 2



"Location Location Location"

This spacious two-bedroom apartment is ideally located just a stones throw from the town centre and a short distance from the mainline railway line with access to London St Pancras in under an hour. The interior is well-presented and comprises entrance hallway leading to a huge open plan kitchen/dining/living room with fitted kitchen. You will find a modern fitted bathroom and two generous double bedrooms, the master with en-suite. Outside there is a designated parking space.

Key Features

- First Floor Apartment
- Two Bedrooms
- Leasehold -125 Years from 2002
- Service Charges - £1150 pa and Ground Rent £200 pa
- Ensuite and Main Bathroom
- Parking for One Car
- Double Glazing
- EPC Rating: PENDING
- No Chain
- COUNCIL TAX: B

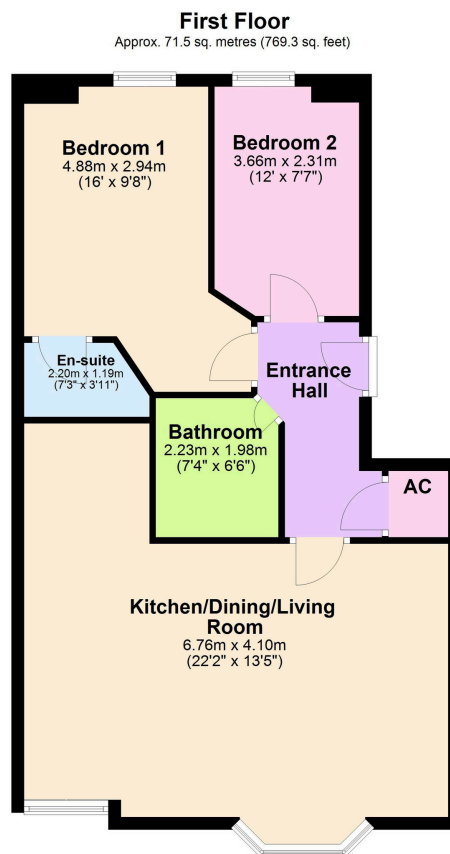

Total area: approx. 71.5 sq. metres (769.3 sq. feet)

